

D. 33. 265
A 14-105

James Gregg.

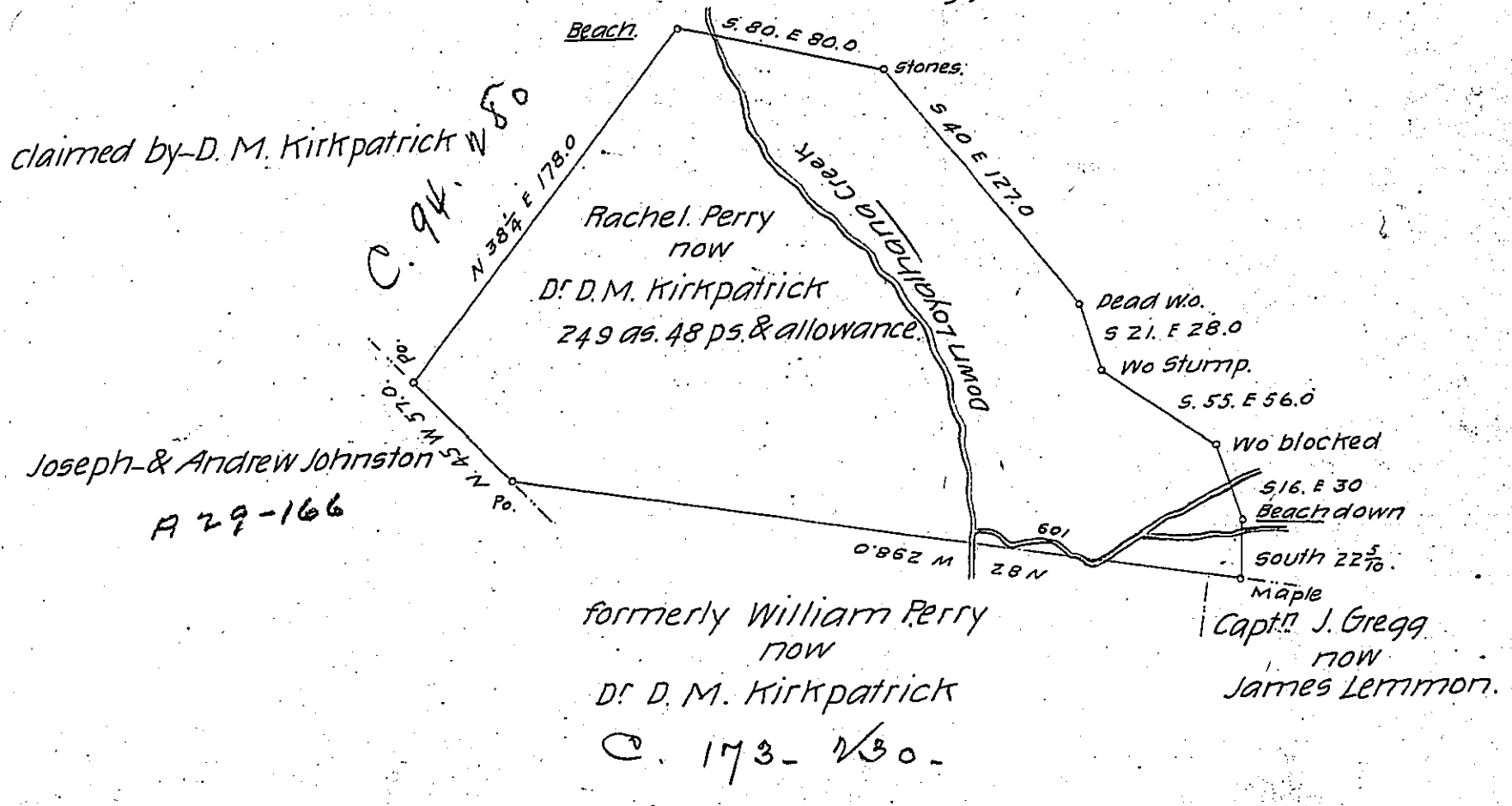

September 8th 1832 Surveyed the above in Pursuance of a Warrant granted to Rachel Perry dated 27th day of Septm 1786 Situate in Salem and Derry townships (the Loyalhana Creek being the line.) Westmoreland County Pa. Containing Two hundred & forty nine acres forty eight perches and the usual allowance of Six P. Ct for Roads & Cr.

C. Fullwood D.S.

To Jacob Spangler Esquire
Surveyor Genl - Com - Pa.

IN TESTIMONY that the above is a copy of the original remaining on file in the Department of Internal Affairs of Pennsylvania, made conformably to an Act of Assembly approved the 16th day of February, 1833, I have hereunto set my Hand and caused the Seal of said Department to be affixed at Harrisburg, this twenty second day of June 19 05.

James R. Brown
Secretary of Internal Affairs.